

425 S. Telshor Blvd.
Suite C-103
Las Cruces, NM
88011-8237

www.bhinc.com

voice: 505.532.8670
facsimile: 505.532.8680
toll free: 800.877.5332

August 30, 2004

Mr. David Boyd, Construction Coordinator
Gadsden Independent School District
PO Drawer 70
Anthony, NM 88021

RE: Contract Award Recommendation
Gadsden Independent School
San Miguel Elementary School Paved Bus Drop Off
BHI Project No: 050060, GISD No. 04-05-01

Dear Mr. Boyd:

Bids were reviewed for the above-reference project. The project consists of the construction of a Paved Student Bus Drop off at San Miguel Elementary School including site work, paving, sidewalk, drainage, and chain link fence.

The bid review and certification form showing bid amounts is attached as Exhibit 1. There were no protests or irregularities prior to or after the bid opening.

The project was bid with a total unit price basis. The three lowest bids received, are as follows:

	Total Bid
Highland Enterprise Las Cruces, New Mexico	\$86,970.58
ESA Construction El Paso, Texas	\$88,500
New Mex Paving Co. El Paso, Texas	\$99,870
<i>Engineer Estimate</i>	\$82,765

These figures DO NOT include New Mexico Gross Receipts Tax.

The apparent low bidder is:

Highland Enterprise, Inc NM Contractor License No. 4460
PO Box 2409
Las Cruces, NM 88004

The low bid is 5% higher than our estimate for the project. We have worked with Highland Enterprise, Inc on this type of work for the Hatch Public School District, and satisfactory work has been done on all of these projects. Satisfactory work has been done on all of these projects.

ENGINEERING 

SPATIAL DATA 

ADVANCED TECHNOLOGIES 

Subject to review of funding availability for the project and on the basis of the above, I recommend that Gadsden Independent School District award **San Miguel Elementary School Paved Bus Drop Off** to Highland Enterprise, Inc in the amount of \$86,970.58. The bid recommendation is based on the base bid and all alternates in accordance with Instruction to Bidders Section 4.10.2 and 7.0 in the Contract Documents.

The Gadsden Independent School District is required to take action (in the form of a vote) to accept or revise this recommendation in accordance with the GISD objectives for award of this construction contract. It is my understanding that consideration of the award will take place at a September 9, 2004 GISD Board meeting. Please do not hesitate to contact me if you have any questions or need further assistance with this prior to that time.

Sincerely,



Michael Smelker, P.E.
Project Engineer
Las Cruces Office

Enclosure

Cc: Highland Enterprise, Inc

GISD, SAN MIGUEL ELEMENTARY SCHOOL PAVED BUS DROP OFF
 BID REVIEW CERTIFICATION
 EXHIBIT 1

Bid Item	Description	Unit	Qty	Engineers Estimate		Highland Enterprise		New Mex Paving Co.	
				Unit Price	Extension	Unit Price	Extension	Unit Price	Extension
1	Mobilization/Demobilization	LS	1	\$ 6,000.00	\$ 6,000.00	\$ 3,285.00	\$ 3,285.00	\$ 8,127.00	\$ 8,127.00
2	All earthwork	LS	1	\$ 10,000.00	\$ 10,000.00	\$ 17,300.00	\$ 17,300.00	\$ 23,000.00	\$ 23,000.00
3	Sub-Grade Preparation & Base Course	SY	1100	\$ 7.00	\$ 7,700.00	\$ 8.50	\$ 9,350.00	\$ 10.82	\$ 11,902.00
4	PMBP asphalt for Bus Drop-off	SY	1100	\$ 7.00	\$ 7,700.00	\$ 7.30	\$ 8,030.00	\$ 11.23	\$ 12,353.00
5	Standard Curb and Gutter for Bus Drop-off	LF	750	\$ 10.00	\$ 7,500.00	\$ 8.85	\$ 6,637.50	\$ 9.50	\$ 7,125.00
6	Concrete rundown	EA	1	\$ 2,000.00	\$ 2,000.00	\$ 915.00	\$ 915.00	\$ 1,050.00	\$
7	Demolition of existing sidewalk	SF	1950	\$ 2.50	\$ 4,875.00	\$ 2.10	\$ 4,095.00	\$ 1.00	\$
8	Sidewalk as shown in the plans	SF	3950	\$ 3.00	\$ 11,850.00	\$ 2.84	\$ 11,218.00	\$ 2.40	\$ 9,480.00
9	Concrete Handicap Ramps	EA	1	\$ 500.00	\$ 500.00	\$ 177.00	\$ 177.00	\$ 720.00	\$ 720.00
10	4" Chain link Fence	LF	240	\$ 11.00	\$ 2,640.00	\$ 18.17	\$ 4,360.80	\$ 10.00	\$ 2,400.00
11	4' X 8" Chain Link Fence Rolling Gate	EA	2	\$ 600.00	\$ 1,200.00	\$ 587.64	\$ 1,175.28	\$ 500.00	\$ 1,000.00
12	6' X 16" Chain Link Fence Rolling Gate	EA	1	\$ 800.00	\$ 800.00	\$ 1,416.00	\$ 1,416.00	\$	\$
13	Signing for Bus Drop-off	EA	4	\$ 200.00	\$ 800.00	\$ 147.50	\$ 590.00	\$ 175.00	\$
14	All Stripping	LS	1	\$ 1,200.00	\$ 1,200.00	\$ 1,097.00	\$ 1,097.00	\$ 1,500.00	\$ 1,500.00
15	Trench Drain	EA	4	\$ 250.00	\$ 1,000.00	\$ 683.50	\$ 2,734.00	\$ 250.00	\$ 1,000.00
16	Material Testing by Contractor per NMDOT	LS		\$ 3,000.00	\$ 3,000.00	\$ 590.00	\$ 590.00	\$ 2,500.00	\$ 2,500.00
17	Modification Allowance	LS	1	\$ 2,000.00	\$ 2,000.00	\$ 2,000.00	\$ 2,000.00	\$ 2,000.00	\$ 2,000.00
18	Close Out Documents	LS	1	\$ 12,000.00	\$ 12,000.00	\$ 12,000.00	\$ 12,000.00	\$ 12,000.00	\$ 12,000.00
TOTAL OF BID ITEM NOS. 1-18				\$	82,765.00	\$	86,970.58	\$	99,807.00

GISD, SAN MIGUEL ELEMENTARY SCHOOL PAVED BUS DROP OFF
 BID REVIEW CERTIFICATION
 EXHIBIT 1

Bid Item	Description	Unit	Qty	ESA Construction		Smith & Aguirre		HO Construction Inc	
				Unit Price	Extension	Unit Price	Extension	Unit Price	Extension
1	Mobilization/Demobilization	LS	1	\$ 9,450.00	\$ 9,450.00	\$ 7,000.00	\$ 7,000.00	\$ 6,000.00	\$ 6,000.00
2	All earthwork	LS	1	\$ 25,000.00	\$ 25,000.00	\$ 20,000.00	\$ 20,000.00	\$ 8,000.00	\$ 8,000.00
3	Sub-Grade Preparation & Base Course	SY	1100	\$ 5.00	\$ 5,500.00	\$ 10.00	\$ 11,000.00	\$ 23.00	\$ 25,300.00
4	PMBP asphalt for Bus Drop-off	SY	1100	\$ 6.00	\$ 6,600.00	\$ 10.00	\$ 11,000.00	\$ 8.36	\$ 9,196.00
5	Standard Curb and Gutter for Bus Drop-off	LF	750	\$ 6.00	\$ 4,500.00	\$ 13.00	\$ 9,750.00	\$ 11.00	\$ 8,250.00
6	Concrete rundown	EA	1	\$ 500.00	\$ 500.00	\$ 2,000.00	\$ 2,000.00	\$ 810.00	\$ 810.00
7	Demolition of existing sidewalk	SF	1950	\$ 1.00	\$ 1,950.00	\$ 0.50	\$ 975.00	\$ 1.00	\$ 1,950.00
8	Sidewalk as shown in the plans	SF	3950	\$ 2.00	\$ 7,900.00	\$ 3.50	\$ 13,825.00	\$ 2.25	\$ 8,887.50
9	Concrete Handicap Ramps	EA	1	\$ 500.00	\$ 500.00	\$ 1,100.00	\$ 1,100.00	\$ 750.00	\$ 750.00
10	4" Chain link Fence	LF	240	\$ 25.00	\$ 6,000.00	\$ 18.00	\$ 4,320.00	\$ 17.16	\$ 4,118.40
11	4" X 8" Chain Link Fence Rolling Gate	EA	2	\$ 500.00	\$ 1,000.00	\$ 600.00	\$ 1,200.00	\$ 858.00	\$ 1,716.00
12	6" X 16" Chain Link Fence Rolling Gate	EA	1	\$ 1,000.00	\$ 1,000.00	\$ 1,400.00	\$ 1,400.00	\$ 896.00	\$ 896.00
13	Signing for Bus Drop-off	EA	4	\$ 125.00	\$ 500.00	\$ 300.00	\$ 1,200.00	\$ 433.12	\$ 1,732.48
14	All Stripping	LS	1	\$ 1,300.00	\$ 1,300.00	\$ 2,400.00	\$ 2,400.00	\$ 2,066.62	\$ 2,066.62
15	Trench Drain	EA	4	\$ 200.00	\$ 800.00	\$ 400.00	\$ 1,600.00	\$ 680.00	\$ 2,720.00
16	Material Testing by Contractor per NMDOT	LS	1	\$ 2,000.00	\$ 2,000.00	\$ 2,500.00	\$ 2,500.00	\$ 1,900.00	\$ 1,900.00
17	Modification Allowance	LS	1	\$ 2,000.00	\$ 2,000.00	\$ 2,000.00	\$ 2,000.00	\$ 2,000.00	\$ 2,000.00
18	Close Out Documents	LS	1	\$ 12,000.00	\$ 12,000.00	\$ 12,000.00	\$ 12,000.00	\$ 15,000.00	\$ 15,000.00
TOTAL OF BID ITEM NOS. 1-18				\$	\$ 88,500.00	\$	\$ 105,270.00	\$	\$ 101,293.00



[Handwritten Signature]
 ENGINEER SIGNATURE
 8/30/04

BID OPENING TABULATION FORM

GISD, San Miguel Elementary School Paved Bud Drop Off

Bid Opening Date: August 26, 2004
 Bid Opening Time: 2:00 pm

Patricia S. [Signature]

Dir. O'Neal Sr

BIDDER	RCPT OF ADDEND	LICENSE NO. & SIGNATURE	SUB-CONTRACTORS	BID BOND.	NON COLLUSION	CONFLICT OF INTEREST	TOTAL BASE BID
Highland ENT.	✓	✓		✓			\$ 86,970.58
N.M. PAVING	✓	✓		✓			\$ 99,807.00
ESA CONST.	✓	✓		✓			\$ 88,500.00
SMITH & AGUIRAE	✓	✓		✓			\$ 105,270.00
H.O. CONST.	✓	✓		✓			\$ 101,293.00
Engineer's Estimate							\$83,000

NOTE: Certified Bid Tabulation to follow

08/30/2004 16:34 FAX 505 532 8680 BOHANNAN HUSTON 006

KEYED NOTES

- 1** INSTALL NEW HEADER CURB
- 2** INSTALL 2" HMAC PER NMSHTD. STANDARDS
- 3** INSTALL NEW SIDEWALK
- 4** BUILD HANDICAP RAMP
- 5** REMOVE EXISTING SIDEWALK AND REPLACE WITH NEW SIDEWALK
- 6** NEW 4' HIGH CHAIN LINK FENCE
- 7** INSTALL "DO NOT ENTER" SIGN
- 8** INSTALL "BUSES ONLY" SIGN
- 9** EXISTING SIDEWALK
- 10** EXISTING CHAIN LINK FENCE
- 11** EXISTING CHAIN LINK FENCE GATE

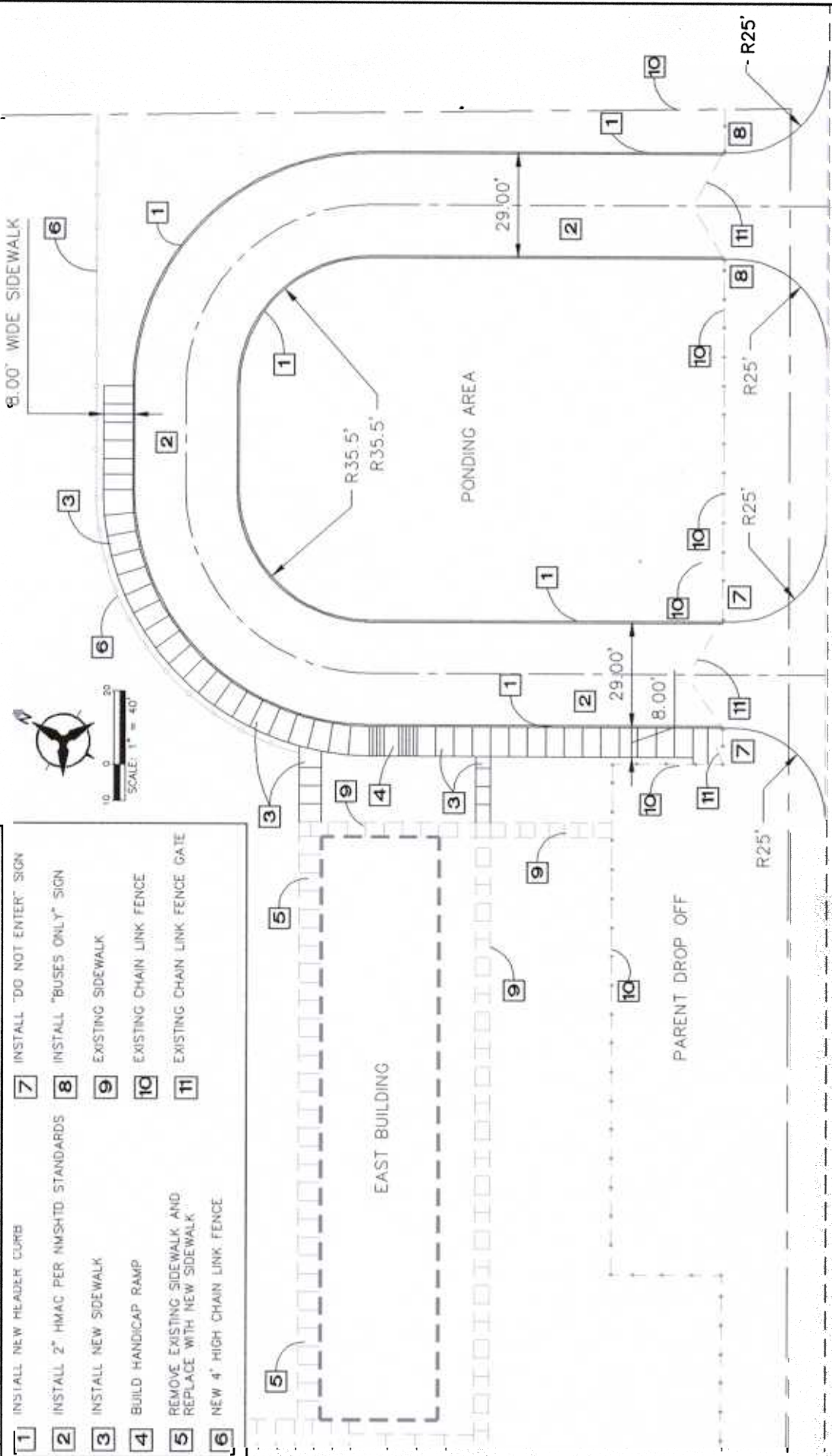

HIGHWAY 228

SITE PLAN